

# Installation Guide

## CROSSMEMBER MOUNT BUSHINGS

SUITS: SUBARU IMPREZA/FORESTER

(Always refer to the current catalogue for complete application listing)

- N.B:** - This installation guide should be used in conjunction with the workshop manual
- Top mounting washers require tabs to be flattened (Refer to Fig.1)

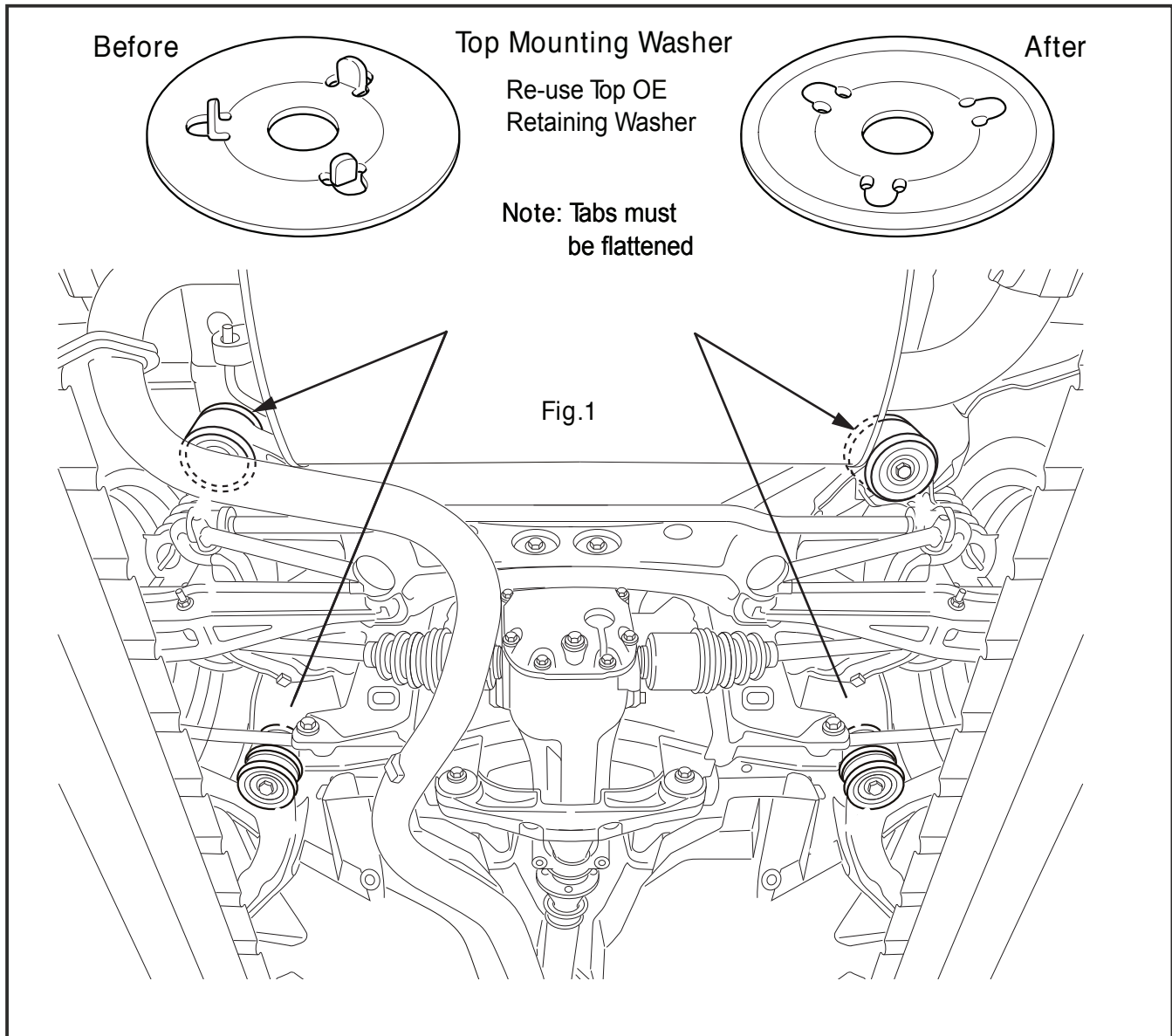

- Raise vehicle evenly and safely support.
- Lower the rear sub-frame and press out the 4 mounting bushings.
- Once removed, confirm all 4 eyelets are clean and free of dirt.
- Place bushing 67150 into top of eyelet.
- Place bushing 67151 into bottom of eyelet.
- Grease ID and outer flange area of bushings, then insert supplied tubes.
- Note - top washer tabs need flattening - see above.
- Re-fit Sub-frame to vehicle.

N.B: It is recommended that a licenced workshop or trades person carry out the above procedure and that workshop manual and relevant safety procedures are followed in addition to the above.