

FIRST TIME INSTALLATION

- Please read instructions carefully before installation.
- Check the contents of kit. Contact your YAKIMA dealer if any parts appear missing or damaged.
- Clean your roof rack/platform prior to fitting the YAKIMA LightN'Up Light Bracket Kit.
- Place these instructions in the vehicle's glove box after installation is complete.

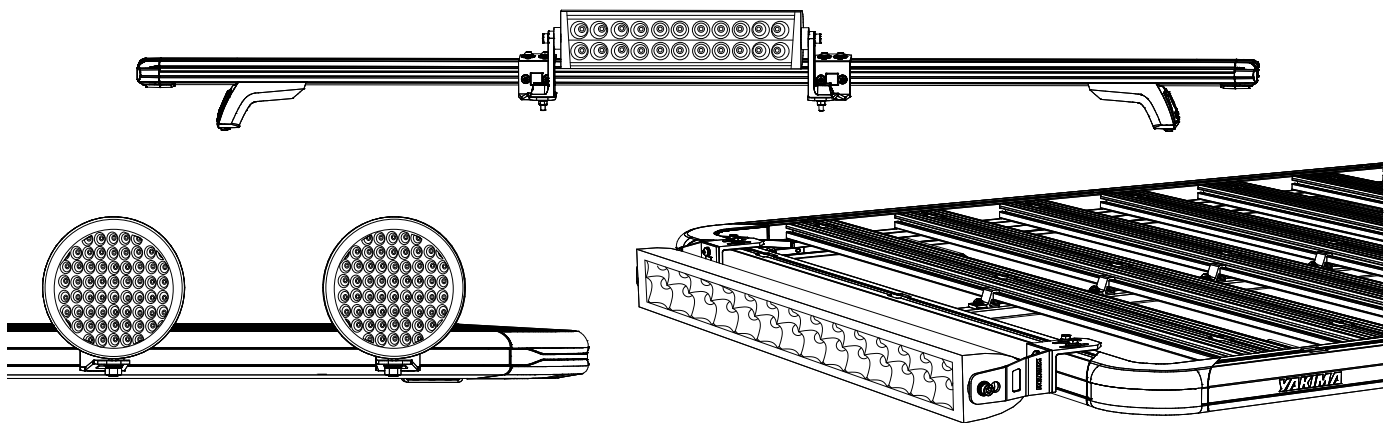

PLATFORM AND BAR SOLD SEPARATELY

KIT CONTENTS

ITEM	COMPONENT	QTY
1.	M6 Spring Nut	x4
2.	M6 Slot Nut	x4
3.	M6 Washer Spring	x10
4.	M6 Washer 12 X 1.5mm	x6
5.	M6 Button Head Screw 20mm	x4
6.	M6 Button Head Screw 12mm	x4
7.	M8 Washer	x2
8.	M8 Spring Washer	x2
9.	M10 Spring Washer	x2
10.	M10 Washer	x2
11.	Light Bracket Arm B	x1
12.	Light Bracket Arm A	x1
13.	Light Bracket Base	x2
14.	M6 Washer 18 X 1.6mm	x4
15.	Torx Key	x1
16.	M6 Button Head Screw 16mm	x4
17.	Light Bracket Base Bump On	x2

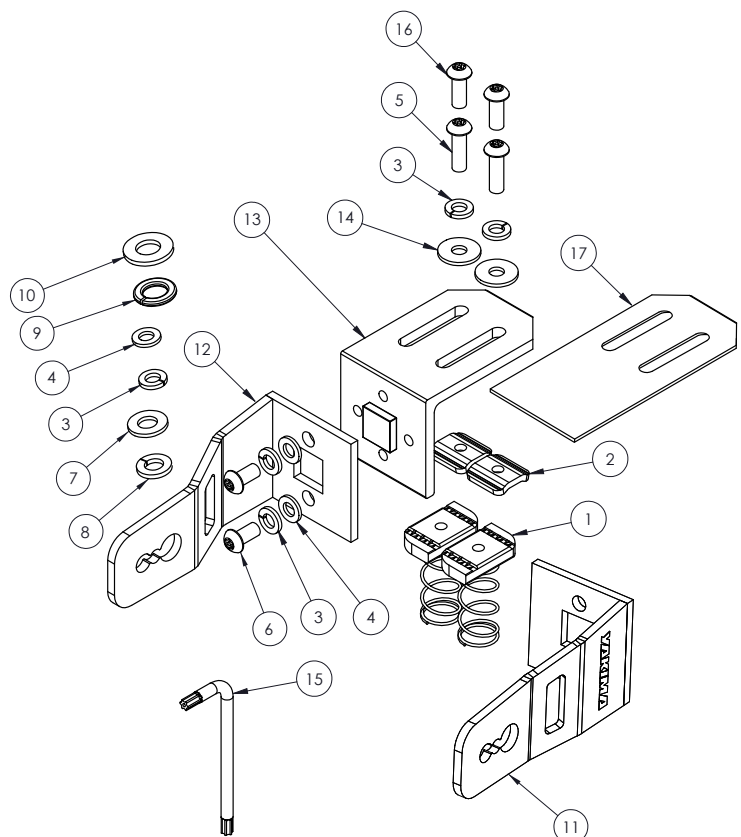

MAX LOAD RATING: 10KG

LIGHT BAR INSTALLATION

1 CONFIGURATIONS

The Light Bracket Base can be mounted to your Bar or Platform orientated up or down as shown.



There are 4 different Arm mounting configurations for each Base orientation as shown:

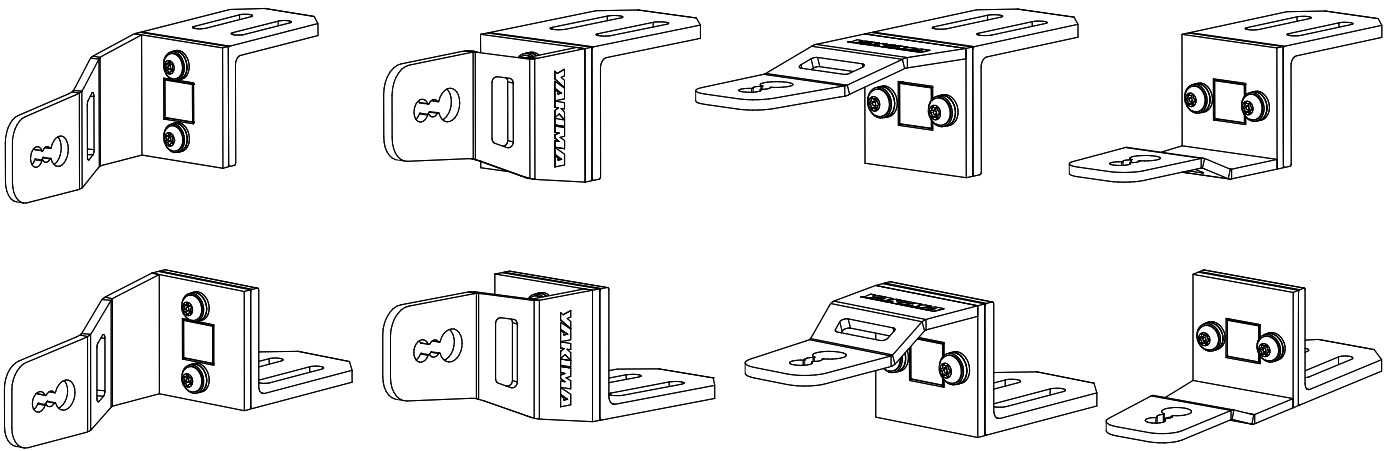

Side mounted with Arm angled down

Side mounted with Arm angled up

Top mounted

Bottom mounted

2 ATTACH BUMP ON TO BRACKET BASES - DOWNWARDS ORIENTATION ONLY

NOTE - This step is not required for LOCKN'LOAD bars or any mounting surface that is already protected.

Bump On tape is to be applied to the inside surface of down facing Bracket Bases. Remove backing tape from Bump On Strips and firmly apply to the underside of each Bracket Base as shown.

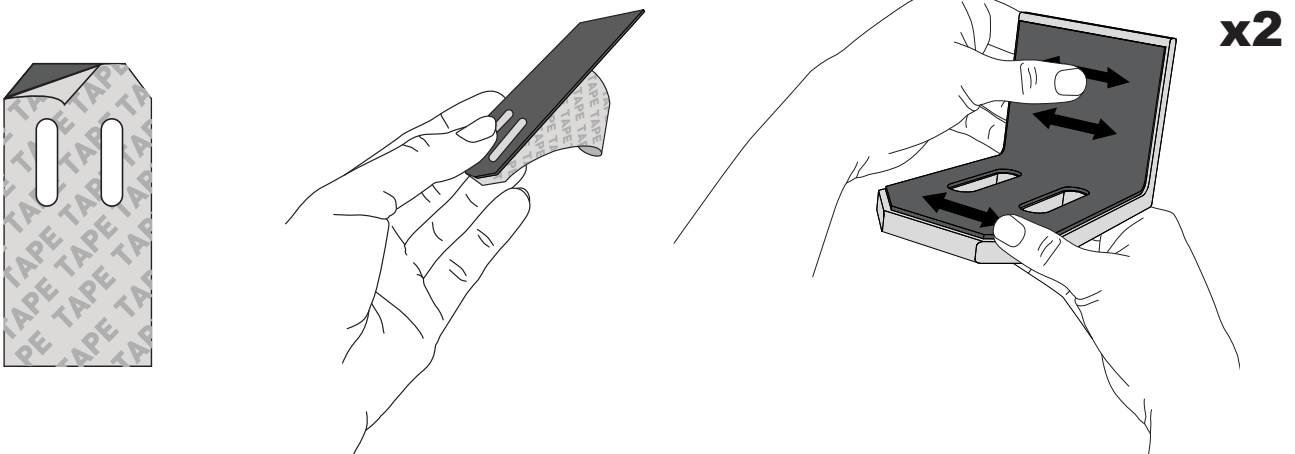
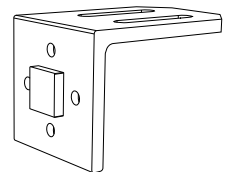

3

ASSEMBLE BRACKETS

Assemble the Base Brackets and Arm Brackets in the chosen orientation (refer to Step 1 for configuration options) using 2 x M6 Washers 12 X 1.5mm, 2 x M6 Spring Washers and 2 x M6 Button Head Screws 12mm as shown for each Bracket assembly.

Tighten to all Screws to 7Nm with Torx Key provided.

NOTE - Example orientation shown is of Base down with Arms side mounted angled down. This is best suited to mounting long Light Bars.

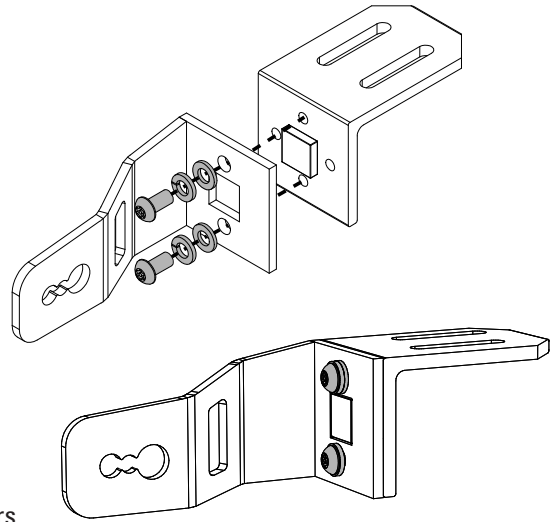

4

SELECT CORRECT MOUNTING HARDWARE

Select the correct mounting hardware option as shown below. Platform uses M6 Slot Nuts and Bars use M6 Spring Nuts.

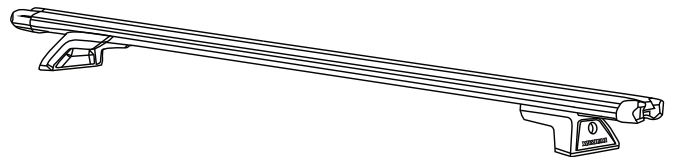
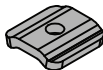
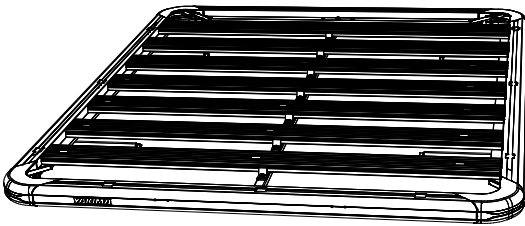

4a

INSERT MOUNTING HARDWARE - PLATFORM

Insert 4 x M6 Slot Nuts into the platform channel where you want to mount your light accessory. Refer to Step 6 for positioning information.

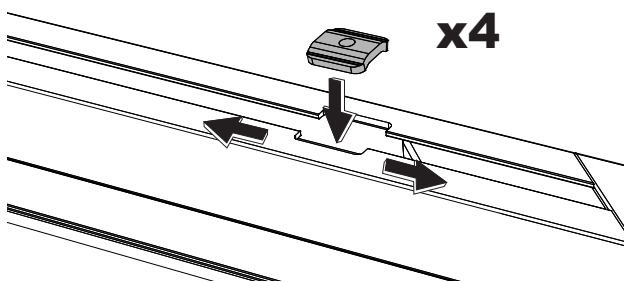

NOTE - Light Brackets can be fitted to all four sides of the LOCKN'LOAD Platform.

4b

INSERT MOUNTING HARDWARE - CROSSBAR

Insert 4 x M6 Spring Nuts into the crossbar channel where you want to mount your light accessory. Push Spring Nuts down into crossbar channel and twist to lock into place as pictured. Refer to Step 6 for positioning information.

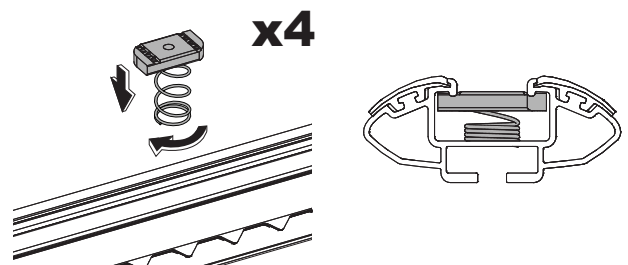

5**LIGHT BAR HARDWARE**

Determine whether your light bar uses M6, M8, M10 or M12 screws. The overlapping holes as shown from left to right are for M10/12, M6 and M8.

Washers and Spring Washers are provided in the LOCKN'LOAD Light Bracket Kit to prevent damage to your Brackets.

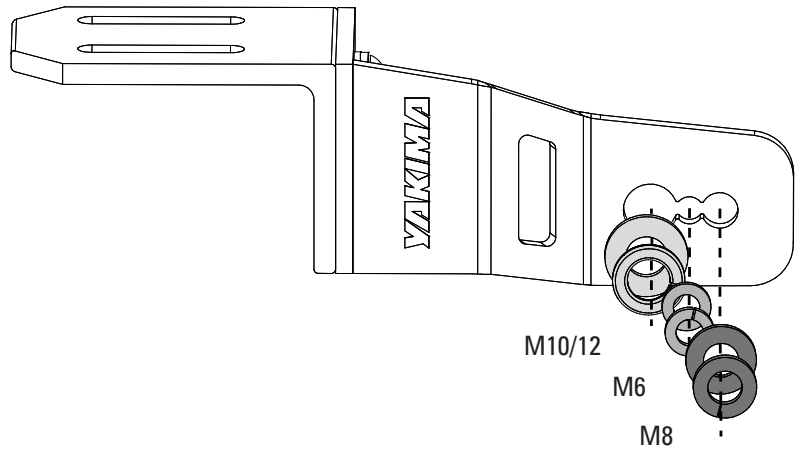
**6****ATTACH BRACKET ASSEMBLIES TO LIGHT BAR**

Attach the 2 Bracket assemblies to your light bar using the screws supplied within your light bar kit and the appropriate sized washers supplied in the LOCKN'LOAD Light Bracket Kit.

Finger tighten screws to allow the light bar to be adjusted once mounted.

NOTE - M8 Light Bar hardware is shown in this example.

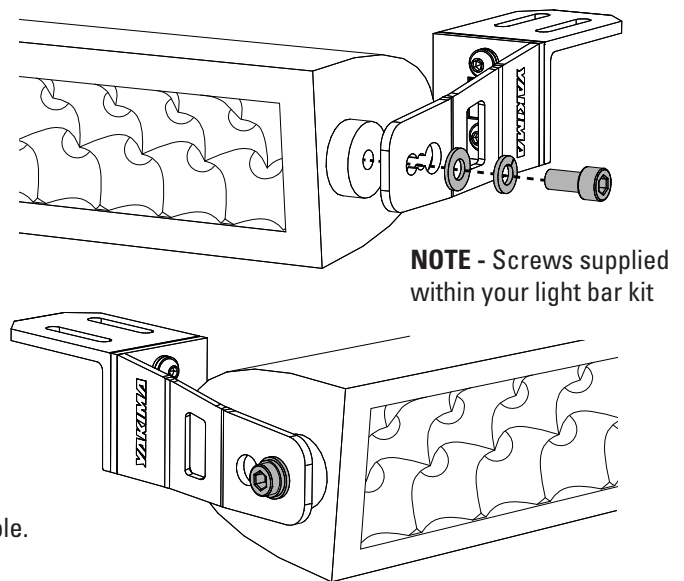
**7****CENTRE LIGHT BAR AND ADJUST SLOT/SPRING NUTS**

Position and centre light bar and Bracket assembly on Platform or Crossbar by ensuring there is an equal distance from the Platform corners or Crossbar ends as shown. Adjust Slot/Spring nuts in the channel so that they align with the openings in Bracket Bases. The Torx Key can be used to assist Nut movement within the channel.

NOTE - Ensure that position of light bar, or multiple light bars, complies with relevant state legislation.



8**POSITION BRACKET ASSEMBLIES ON PLATFORM/CROSSBAR**

When the Bracket Base is facing down, it must be pushed as far back as possible, so it sits flush against the front of Platform/Crossbar as shown.

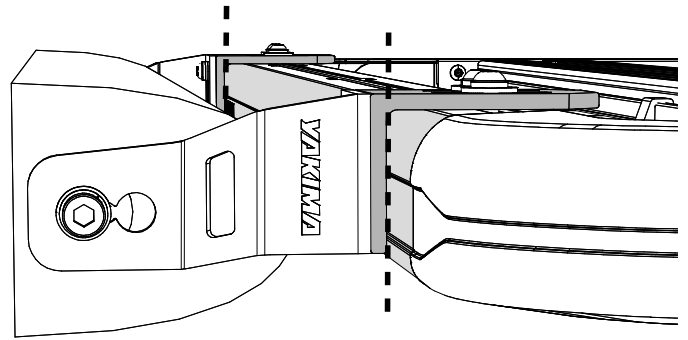

When the Bracket Base is facing up, the front face is to be in line with the front of Platform/Crossbar as shown.

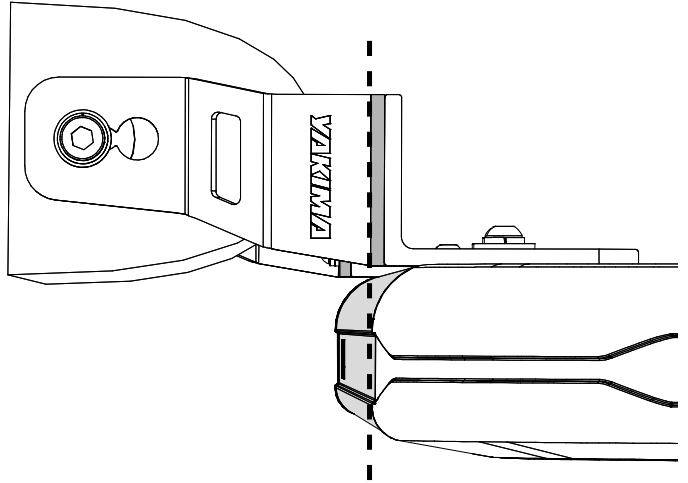
**8a****SECURE LIGHT BAR TO PLATFORM**

Secure light bar and Bracket assembly to the Slot Nuts within channel using 2 x M6 Button Head Screws 16mm, 2 x M6 Spring Washers and 2 x M6 Washers 18 X 1.6mm as shown for each Bracket assembly.

Tighten all Screws to 7Nm with Torx Key provided.

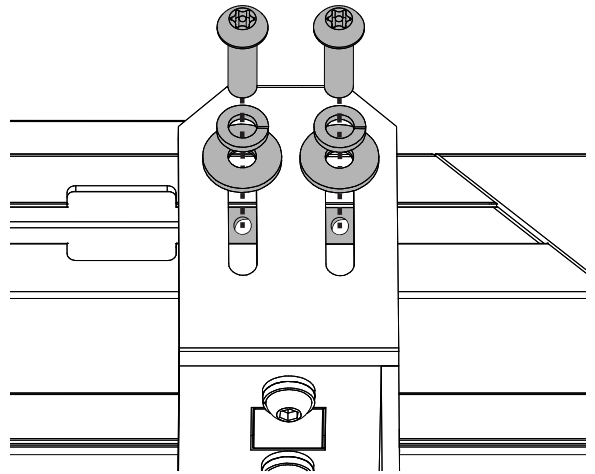
**8b****SECURE LIGHT BAR TO CROSSBAR**

Secure light bar and Bracket assembly to the Spring Nuts within channel using 2 x M6 Button Head Screws 20mm, 2 x M6 Spring Washers and 2 x M6 Washers 18 X 1.6mm as shown for each Bracket assembly.

Tighten all Screws to 7Nm with Torx Key provided.

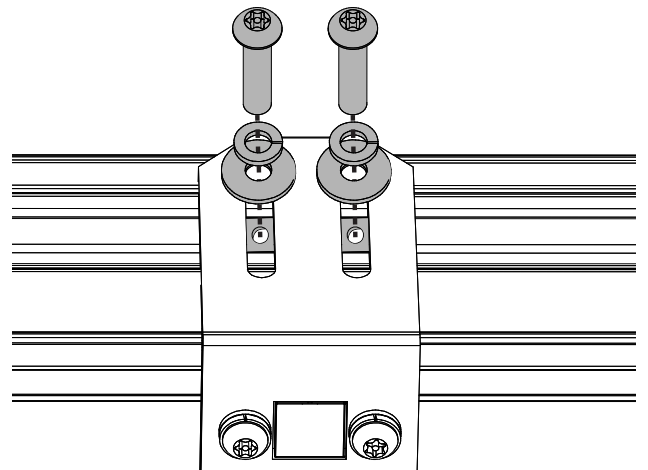

9**ADJUST LIGHT BAR AND TIGHTEN SCREWS**

Adjust light bar to preferred angle then tighten light bar hardware installed in Step 5 according to the manufacturer's instructions.

Installation is now complete.

Ensure all screws are regularly checked and tightened to ensure minimal bounce and maximum safety.

Ensure all wiring is retained according to Light Bar manufacturer instructions.

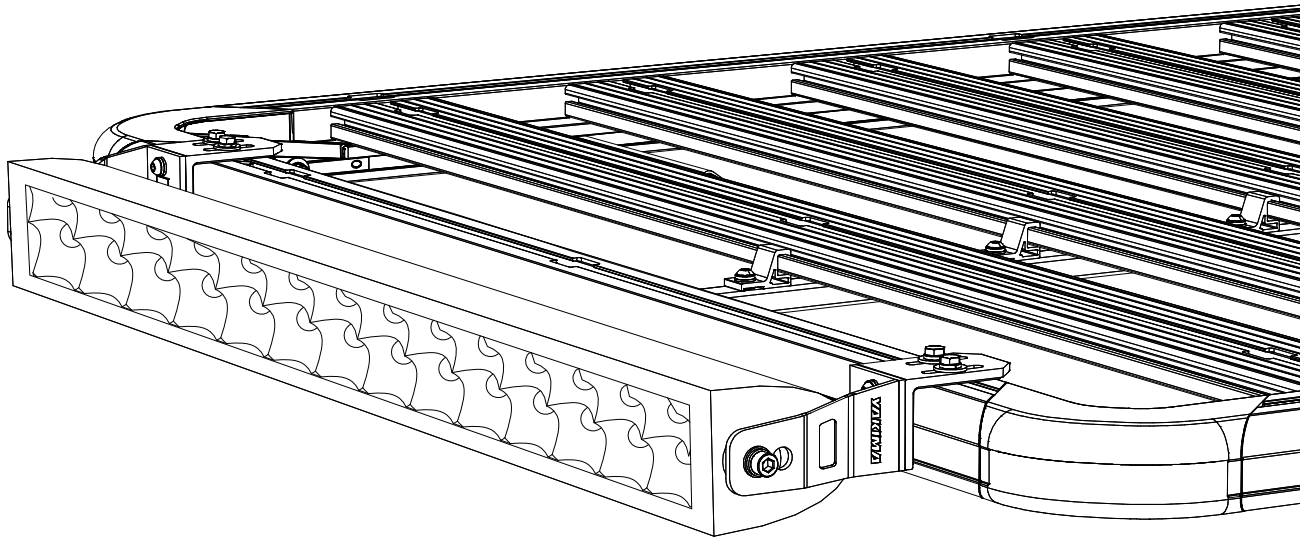
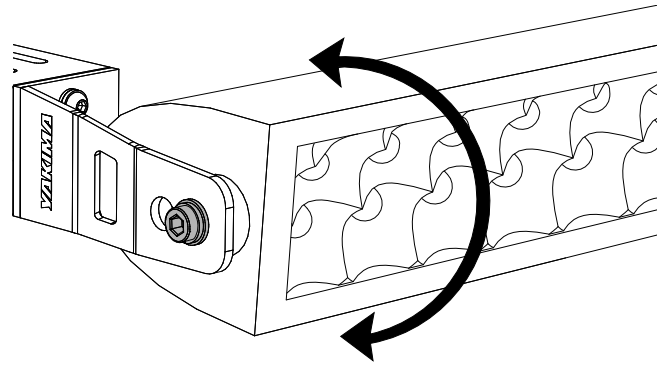

SPOT LIGHT INSTALLATION

A CENTRE BRACKET ASSEMBLIES AND ADJUST TEE/SPRING NUTS

Follow Steps 1 - 4 for light bar installation, then position and centre Bracket assemblies on Platform or Crossbar by referring to Step 8 for light bar installation. Ensure there is an equal distance from the Platform corners or Crossbar ends as shown. Adjust Slot/Spring nuts in the channel so that they align with the openings in Bracket Bases. The Torx Key can be used to assist Nut movement within the channel.

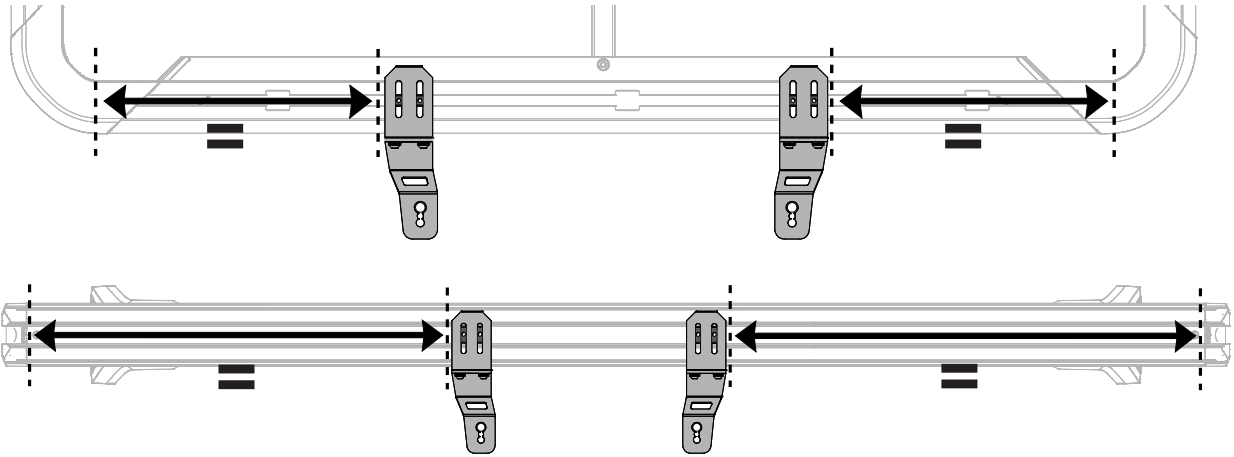

NOTE - Example orientation shown is of Base down with Arms bottom mounted. This is suitable for mounting spot lights.

B1 SECURE BRACKET ASSEMBLIES TO PLATFORM

Secure Bracket assemblies to the Slot Nuts within channel using 2 x M6 Button Head Screws 20mm, 2 x M6 Spring Washers and 2 x M6 Washers 18 X 1.6mm as shown for each Bracket assembly.

Tighten all Screws to 7Nm with Torx Key provided.

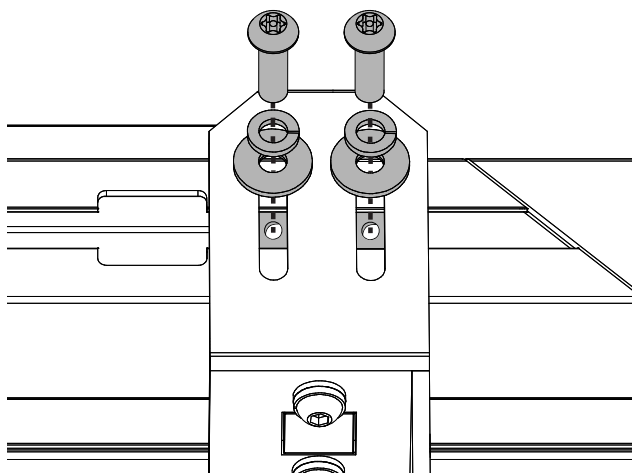

B2 SECURE BRACKET ASSEMBLIES TO BAR

Secure Bracket assemblies to the Spring Nuts within channel using 2 x M6 Button Head Screws 20mm, 2 x M6 Spring Washers and 2 x M6 Washers 18 X 1.6mm as shown for each Bracket assembly.

Tighten all Screws to 7Nm with Torx Key provided.

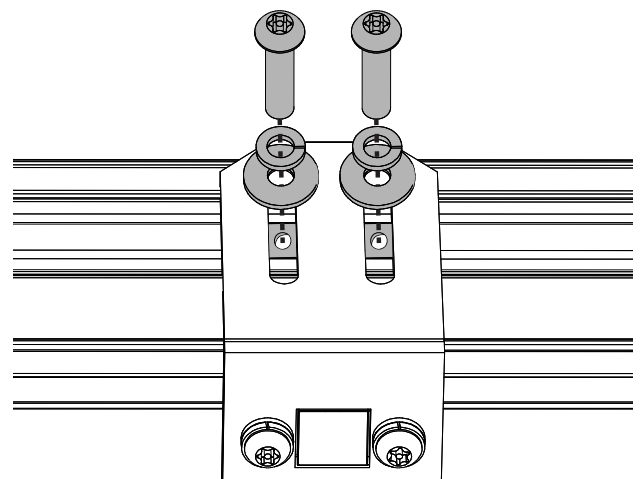



SPOT LIGHT HARDWARE

Determine whether your spot light uses M6, M8, M10 or M12 nuts. The overlapping holes as shown from right to left are for M10/12, M6 and M8.

Washers and Spring Washers are provided in the LOCKN'LOAD Light Bracket Kit to prevent damage to your Brackets.

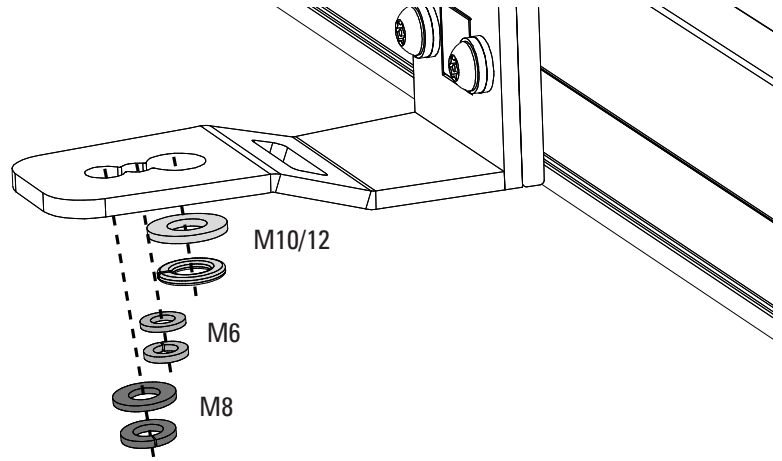

MOUNT SPOT LIGHTS TO BRACKET ASSEMBLIES

Mount spot lights to the two Bracket assemblies using the nuts supplied within your spot light kit, and the appropriate sized washers supplied in the LOCKN'LOAD Light Bracket Kit.

Adjust spot lights to preferred angle then tighten spot light hardware according to the manufacturer's instructions.

NOTE - Ensure that position and arrangement of spot lights complies with relevant state legislation.

Installation is now complete.

**Ensure all nuts are regularly checked and tightened to ensure maximum safety.
Ensure all wiring is retained according to Spot Light manufacturer instructions.**

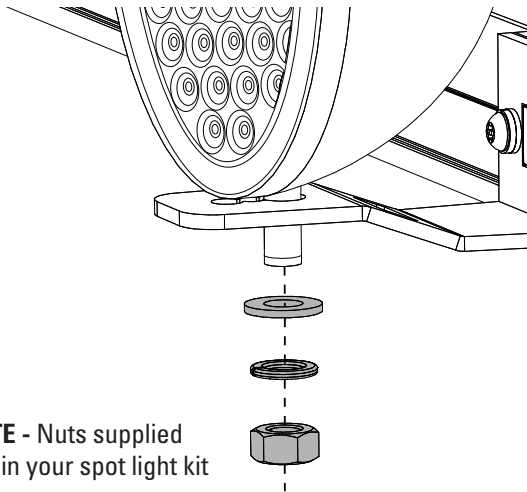

NOTE - Nuts supplied within your spot light kit

NOTE - M10/12 spot light hardware is shown in this example.

