

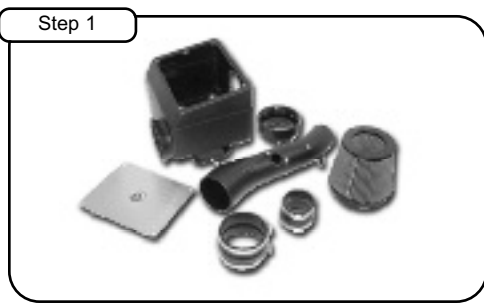

Intake Kit Installation Instructions: Toyota Tacoma / 4Runner / FJ '03-'09 V6-4.0L

Kit P/N: 51/54-81162	Tools Required: 5/16" Nut Driver 10mm Socket W/ Extension and Ratchet 12mm Socket W/ Extension and Ratchet 13mm Socket W/ Extension and Ratchet Flat Head/Slotted Screwdriver 5/32" Allen Wrench	Part List: 1) Air Filter 1) Tube, Intake 1) Housing, Intake 1) Coupler, Reducer (05-01400) 1) Clamp, #048 1) Clamp, #052 2) Clamp, #072 1) Trim Seal 3/4" (15.5" Length) 9) Screw Button Head, M6x1x10 1) Hose 5/32" (16" Length) 1) Washer Flat, M8 2) Screws, M4 (MAF Sensor) 1) Gasket, MAF Sensor 1) Adaptor, Intake 2) Spacer Nylon 1) Isolation Mount, M8 1) Nut Hex, M8 1) Cover, Intake 1) Brass Fitting Hose, 3/16 x 1/8 1) Coupler, Hump (05-01399)
-----------------------------	---	--



Step 1 Complete kit with parts.

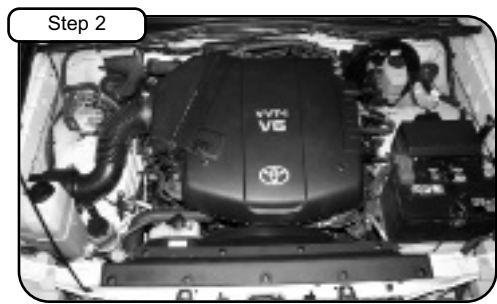

Step 2 Complete stock intake.

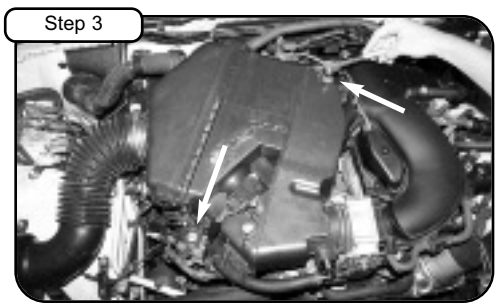

Step 3 Remove engine cover with 10mm socket. With 10mm socket remove the 2 bolts holding in OE airbox. Disconnect the MAF sensor.

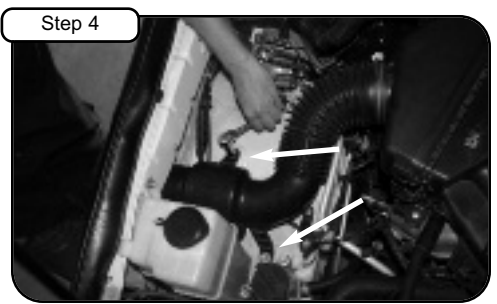

Step 4 With 12mm socket, loosen the two bolts holding in OE intake snorkel.

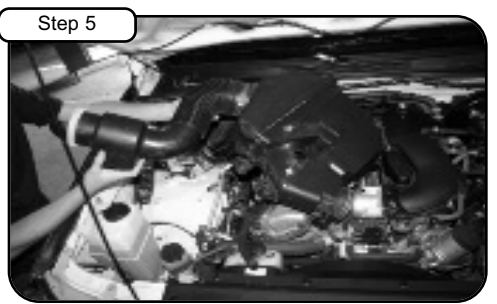

Step 5 Disconnect vacuum and valve cover vent line. Remove OE intake out of vehicle. (Remove and save the two OE rubber grommets & spacers that hold in airbox from step 3)

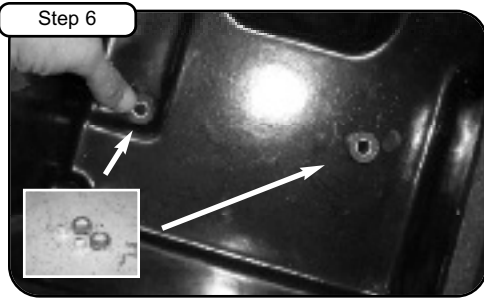

Step 6 With grommets removed from OE intake, place onto new housing with metal spacers.

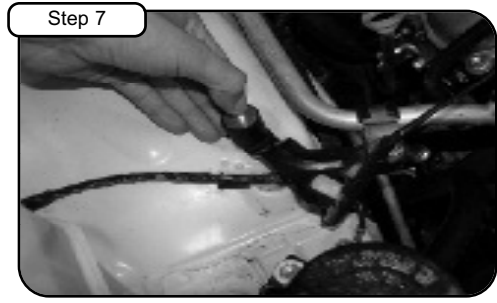

Step 7 With 10mm socket and extension, remove bolt holding AC bracket. Insert M8 isolation mount and hand tighten firmly. (It may be necessary to clean the threads of undercoating or paint)

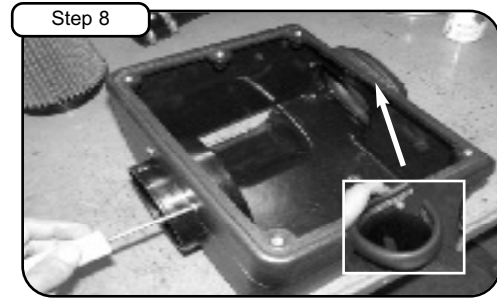

Step 8 Place intake adaptor into housing. Use M6 button head screws provided to attach adaptor and tighten using 5/32" allen wrench. Place 3/4" trim seal onto side vent of housing.



Step 9 Place housing into vehicle and tighten using 12mm socket or wrench. With M8 nut and washer provided tighten down housing onto isolation mount with 13mm wrench.

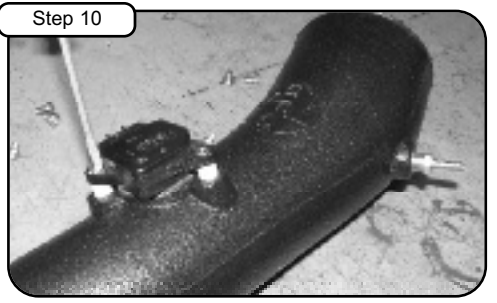

Step 10 Remove MAF sensor from OE airbox using phillips screwdriver. Re-install to new aFe tube with hardware provided using flat head screwdriver (make sure gasket and nylon spacers are between tube and sensor). Install brass hose fitting.



Step 11 Place coupler 05-00794 with clamps #072 onto tube for adaptor side of housing. Then place coupler 05-00815 with clamps #052 and #048 onto tube for throttle body side. Install loose to allow repositioning.

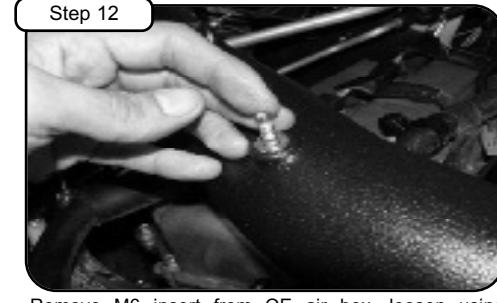

Step 12 Remove M6 insert from OE air box, loosen using adjustable wrench. Re-install on to new tube and tighten. Connect large vent hose and connect small vent hose (5/32" hose provided) between tube and fuel regulator.

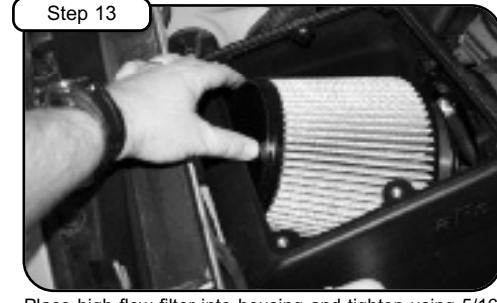

Step 13 Place high flow filter into housing and tighten using 5/16" nut driver. Place cover onto housing using M6 button head screws provided, tighten using 5/32" allen wrench. (Place filter into housing at slight angle)



Step 14 Temporarily install engine cover and position tube to align stud from step 13. Tighten coupler clamps and then tighten engine cover nut using 10mm socket.



Step 15 Place enclosed CARB EO sticker on a clean/smooth surface on or near the intake system. Your installation is now complete. Check all clamps and hoses periodically. Thank you for choosing aFe!