

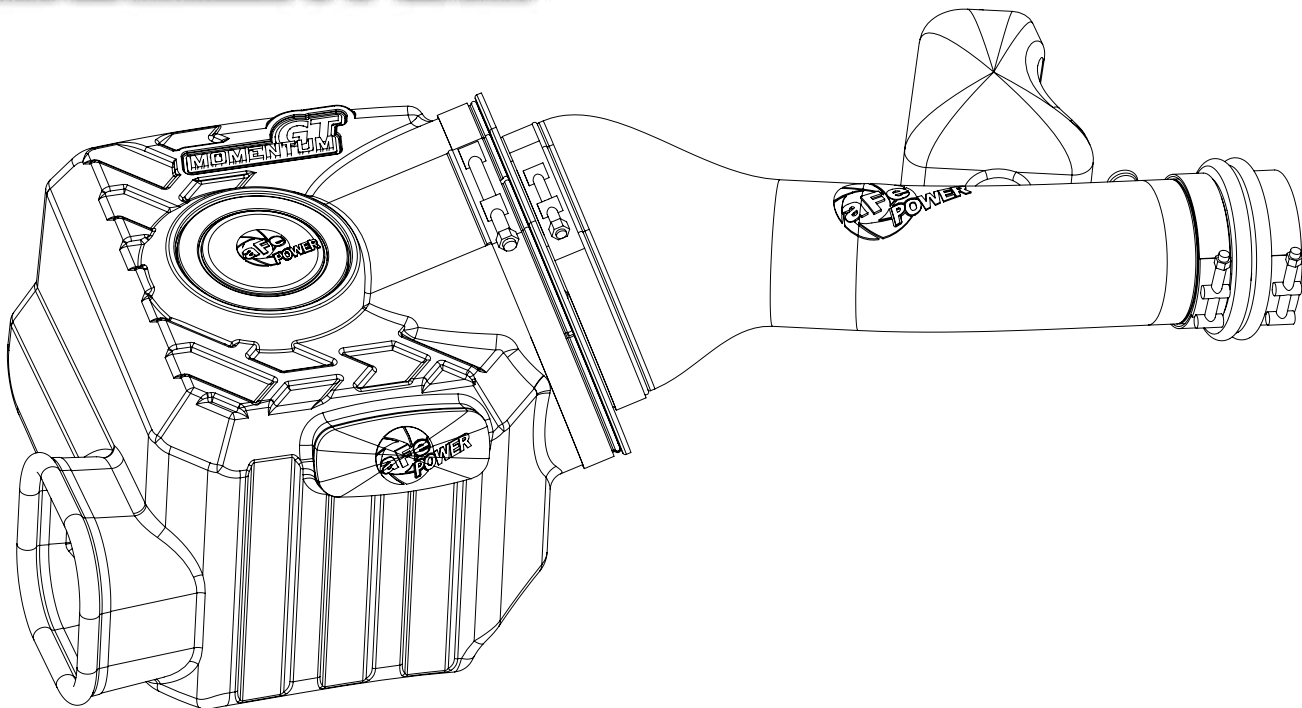

**GT**  
**MOMENTUM™**



**advanced FLOW engineering** Momentum GT Cold Air Intake System

**Instruction Manual** P/N: 51-76009 / 54-76009 / 75-76009

Make: **Toyota** Model: **FJ Cruiser** Year: **2010-2019** Engine: **V6-4.0L**

Make: **Toyota** Model: **4Runner** Year: **2010-2019** Engine: **V6-4.0L**



- Please read the entire instruction manual before proceeding.
- Ensure all components listed are present.
- If you are missing any of the components, call customer support at 951-493-7100.
- Ensure you have all necessary tools before proceeding.
- Do not attempt to work on your vehicle when the engine is hot.

## Retain factory parts for future use.

Label	Qty.	Description	Part Number
A1	1	Air Filter (Pro 5R)	24-91116
A2	1	Air Filter (Pro DRY S)	21-91116
A3	1	Air Filter (Pro-GUARD 7)	72-91116
B	1	Tube	05-76009B1
C	1	Housing	05-76010B2
D	1	Plug, Urethane	05-01225
E	1	Seal, Trim (17" inches)	05-00007
F	1	Clamp, T-bolt (3-1/4" - 3-9/16")	05-50292
G	1	Clamp, T-bolt (3-1/16" - 3-3/8")	05-50320
H	1	Clamp, T-bolt (8-5/16" - 8-5/8")	05-50267
I	1	Coupling, Silicone Reducer	05-01400
J	2	Screw, Torx: M4	03-50491
K	1	Brass Hose Nipple	03-50191
L	1	Isolation Mount	03-50063
M	1	Washer, Flat: M8 x 24mm OD	03-50065
N	1	Hex Nylon Nut	03-50244
O	1	Bolt, M8 x 1.25 x 25mm	03-50442

### Installation will require the following tools:

10mm nut driver, #1 Phillips screwdriver, 11mm deep socket, 12mm & 13mm sockets and drivers and T20 driver.

Note: Legal in California for use on race vehicles only. The use of this device on vehicles used on public streets or highways is strictly prohibited in California and others states that have adopted California emission regulations.

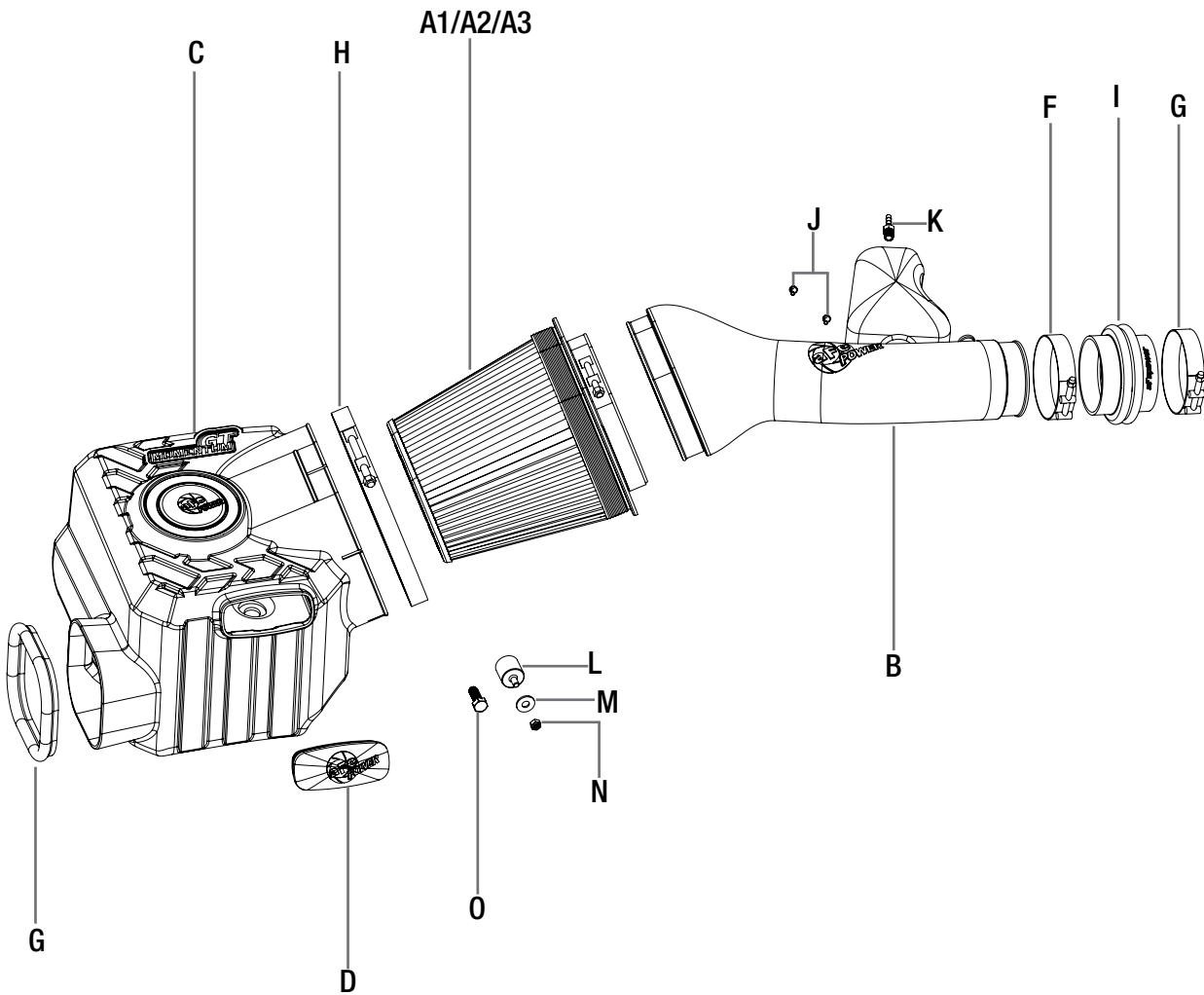

**Figure A****Refer to Figure A for Step 1**

Step 1: Remove the engine cover ① by gently pulling up on the front and disengaging from the hinges at the rear. Set aside.

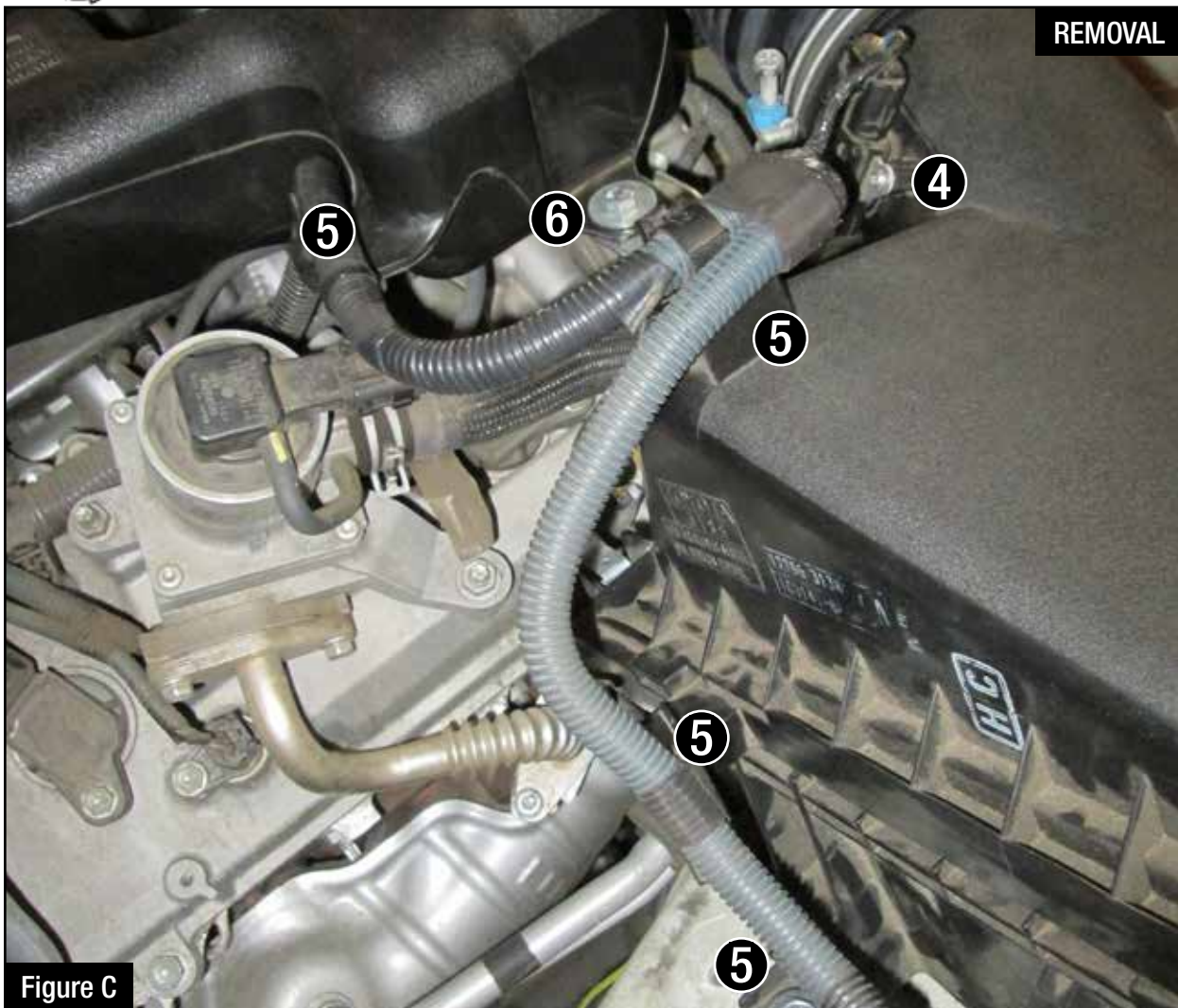

Figure B

**Refer to Figure B for Steps 2-3**

Step 2: Using a 10mm nut driver, loosen the stock clamps (2) at the throttle body and OE airbox.

Step 3: Disconnect the two vent hoses (3) from the stock intake tube.

**Figure C**

**Refer to Figure C for Steps 4-5**

Step 4: Disconnect the Mass Airflow sensor (4) and disengage the wire clips (5) from the stock airbox and rear of the resonance chamber.

Step 5: Using a 10mm socket, remove the screw (6) from the support brace at the resonance chamber. Remove the stock intake tube and set aside.

**Refer to Figure D for Step 6**

Step 6: Disengage the four clips (7) on the OE airbox and remove the top and filter. Set aside.

**Figure E****Refer to Figure E for Step 7**

Step 7: Using a 12mm socket and extension, remove the three screws (8) holding the stock airbox and remove. Retain screws for later use.





Figure F

**Refer to Figure F for Step 8**

Step 8: Using a 10mm socket and extension, remove the retaining screw (9) and support bracket from the vehicle.



**Figure G**

**Refer to Figure G for Step 8**

Step 9: Install the supplied M8 rubber isolation mount (10) into the front-most threaded hole. Hand tighten only.



Figure H

**Refer to Figure H for Step 10**

Step 10: Install the supplied trim seal onto the aFe airbox. Trim to fit.



**Refer to Figure 1 for Step 11**

Step 11: Remove and transfer two steel sleeves and two rubber grommets (11) from the stock airbox to the Momentum housing in the rear most mounting points.



Figure J

**Refer to Figure J for Step 12**

Step 12: Place the aFe airbox into the vehicle and secure using one of the 12mm bolts removed in Step 7 in the left-most mounting location (12). Use the supplied M8 screw in the right-rear mounting location (13) and tighten using a 12mm socket. Using the supplied M8 nut and washer, tighten down the airbox onto the isolation mount (14) using a 13mm socket and driver.



Figure K

**Refer to Figure K for Step 13**

Step 13: Install the supplied large T-bolt clamp (15) onto the airbox and slide the air filter into the airbox. Do not tighten the clamps at this time.



Figure L

**Refer to Figure L for Steps 14-15**

Step 14: Remove the MAF sensor (16) from the OE airbox using a #1 Philips head screwdriver and reinstall into the aFe intake tube using the supplied T20 Torx screws.

Step 15: Install the brass hose fitting (17) in the aFe intake tube and tighten using an 11mm wrench or socket.



Figure M

**Refer to Figure M for Step 16**

Step 16: Install the supplied reducing coupler with the smaller T-bolt clamp (18) onto the throttle body (lettering on the coupler should be away from the throttle body) and tighten the clamp. Place the larger T-bolt clamp (19) on the coupler, but do not tighten at this time.





Figure N

**Refer to Figure N for Steps 17-18**

- Step 17: Install the intake tube into the vehicle by sliding the tube into the coupling on the throttle body first, then into the filter. Tighten all clamps using an 11mm deep socket and driver.  
(As shown in picture)
- Step 18: Connect the crank case vent hose (20) to the aFe intake tube, and connect the 5/32" vacuum hose (21) to the aFe intake tube. Reconnect the MAF sensor (22).



Figure 0

**Refer to Figure 0 for Step 19**

Step 19: Reinstall the engine cover.



Figure P

**Refer to Figure P for Step 20**

Step 20: Use the provided plug (23) to close the additional air inlet if you want to completely seal the airbox. Best performance gains are obtained without the plug. Check that all components are tight and secure. Your installation is now complete. Thank you for choosing aFe Power!

**NOTE: Check all bolts, clamps, and connectors after 100-200 miles.**



Page left blank intentionally

Page left blank intentionally



Pro DRY S Air Filter



P/N: 21-91116

Pro 5R Air Filter



P/N: 24-91116

Pro-GUARD 7 Air Filter



P/N: 72-91116

Blue Squeeze Restore Kit



P/N: 90-50501

Pro DRY S Restore Kit



P/N: 90-59999

Gold Squeeze Restore Kit



P/N: 90-50500

Coilovers



P/N: 101-5600-15 (Front)

Coil Springs



P/N: 102-1650-195 (Rear)

Cat-Back Exhaust System



P/N: 49-46030-B (Blk. Tips)  
49-46030-P (Pol. Tips)

Cat-Back Exhaust System



P/N: 49-46028-B (Blk. Tip)  
49-46028-P (Pol. Tip)

Oil Filter



P/N: 44-LF014

Exhaust Y-Pipe



P/N: 48-46007-YN (Race)

To purchase any of the items above, view airflow charts, dyno graphs, photos, and video; please go to [aFepower.com](http://aFepower.com).

# Warranty

## General Terms:

- aFe warrants their products to be free from manufacturer's defects due to workmanship and material.
- This warranty applies only to the original purchaser of the product and is non-transferrable.
- Proof of purchase of the aFe product is required for all warranty claims.
- Warranty is valid provided aFe instructions for installation and/or cleaning were properly followed.
- Proper maintenance with regular inspections of product is required to insure warranty coverage.
- Damage due to improper installation, abuse, unauthorized repair or alteration is not warranted.
- Incidental or consequential damages or cost, including installation and removal of part, incurred due to failure of aFe product is not covered under this warranty.
- All warranty is limited to the repair and/or replacement of the aFe part. To request Return Goods Authorization ("RGA"), email [RGA@afepower.com](mailto:RGA@afepower.com) or call (951)493-7100. Upon receipt of the RGA, you must return the product to the address provided in the RGA, freight prepaid and accompanied with a dated proof of purchase and the RGA. Upon receipt of the defective product and upon verification of proof of purchase, aFe will either repair or replace the defective product within a reasonable time, not to exceed thirty days.

Product Category	P/N Prefix	Warranty duration
Direct OE Replacement Filters	10, 11, 30, 31, 71, 73	Life of the vehicle
Racing Filters	18	1 year
Universal	21, 24, 72, TF	2 years
Air Intake Systems	50, 51, 54, 55, 75, TR, TA, TL	2 years
Exhaust Systems	49	2 years
Intercoolers & Intercooler Tubes	46-2	2 years
Intake Manifolds	46-1	2 years
Differential Cover	46-7	Life of the vehicle
Exhaust Manifolds	46	2 years
Throttle Body Spacers	46-3	2 years
Turbochargers	46-6	2 years*
Fluid Filters	44	90 days
Pre-Filters	28	2 years
Heavy Duty OE Replacement	70	2 years
PowerSports OE Replacement	81, 87	2 years
PowerSports Intake Systems	85	2 years

No other warranty expressed or implied applies nor is any person or advanced FLOW engineering authorized to assume any other warranty. Some States do not allow the exclusion or limitation of incidental or consequential damages or do not allow limitations on how long an implied warranty lasts, so the above limitations or exclusions may not apply to you. This warranty gives you specific legal rights, and you may also have other rights which vary from State to State.

\*See turbocharger warranty for more info



**advanced FLOW engineering, inc.**

252 Granite Street Corona, CA 92879

TEL: 951.493.7100 • TECH: 951.493.7134